

# MODEL 75 FRONT FACER

**SIP**<sup>TM</sup>  
SIMPLEX IDEAL PEERLESS



Contents include:

- 1) Front facer with disc and pad
- 3) Angle Pads
- 2) Wrenches
- 5) Replacement discs
- 2) Instruction Sheets

Reorder number for discs (10 per package)

77813-10 40 grit

77813-14 80 grit

77813-15 120 grit

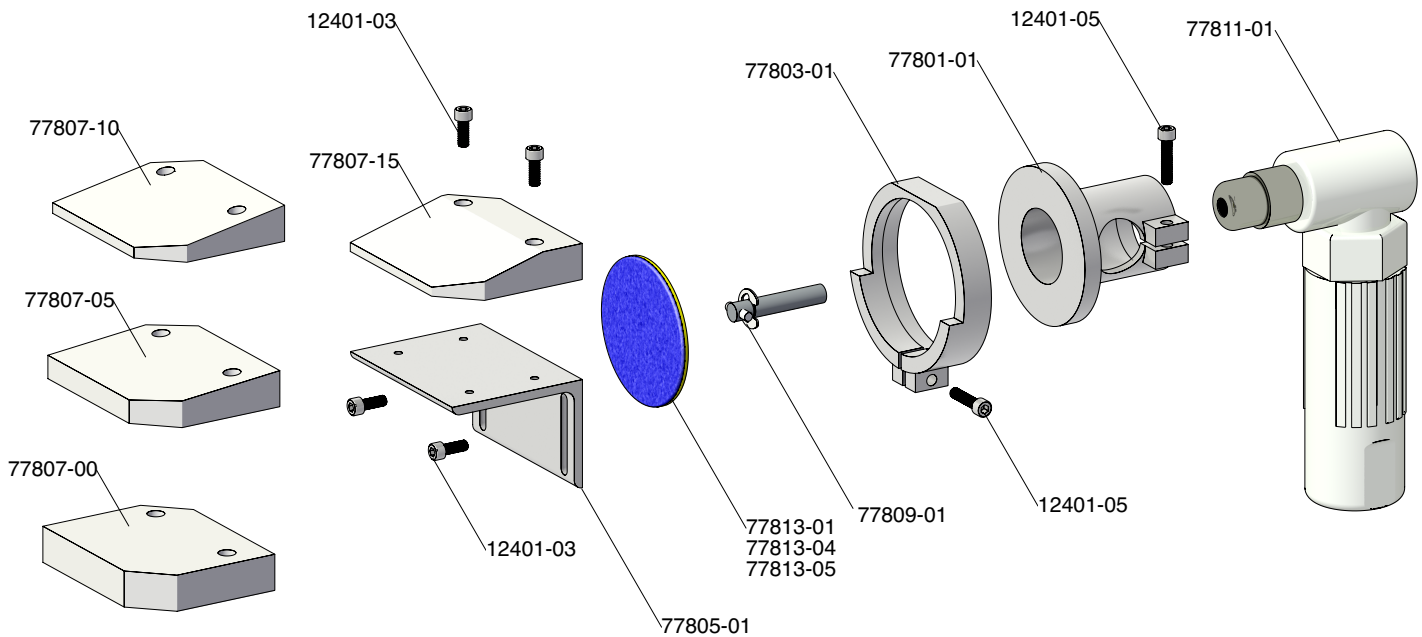

| Part Number | Quantity | Description                       |
|-------------|----------|-----------------------------------|
| 12401-03    | 4 each   | #6-32 x 3/8 Socket Head Cap Screw |
| 12401-05    | 2 each   | #6-32 x 5/8 Socket Head Cap Screw |
| 77801-01    | 1 each   | Tube Body                         |
| 77803-01    | 1 each   | Guide Ring                        |
| 77805-01    | 1 each   | Angle Mount                       |
| 77807-00    | 1 each   | 0° Angle Plate                    |
| 77807-05    | 1 each   | 5° Angle Plate                    |
| 77807-10    | 1 each   | 10° Angle Plate                   |
| 77807-15    | 1 each   | 15° Angle Plate                   |
| 77809-01    | 1 each   | Arbor                             |
| 77811-01    | 1 each   | Air Grinder                       |
| 77813-01    | 2 each   | 40 Grit Grinding Disc             |
| 77813-04    | 2 each   | 80 Grit Grinding Disc             |
| 77813-05    | 2 each   | 120 Grit Grinding Disc            |

# MODEL 75 FRONT FACER

**SIP**<sup>TM</sup>  
SIMPLEX IDEAL PEERLESS

## Grinding with the front facer



Place the nylon pad on the bottom of the bed knife just in from the end and hold the grinding disc away from the bed knife edge.



The front facer comes with four angle pads; 0°, 5°, 10° and 15°, which can be mounted to give either a positive or negative relief angle. Refer to your mowers manual to determine which pad to use.

## Replacing the disc

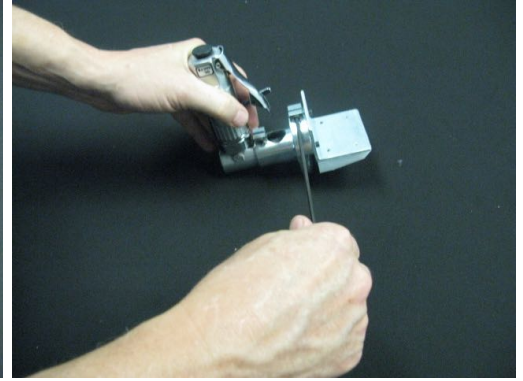

Loosen the clamp screw.



Pull the trigger of the front facer and push it against the bed knife.

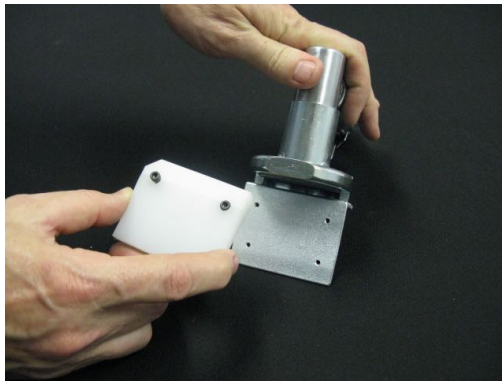

Remove the two socket head screws which secure the nylon pad and replace with the selected pad.

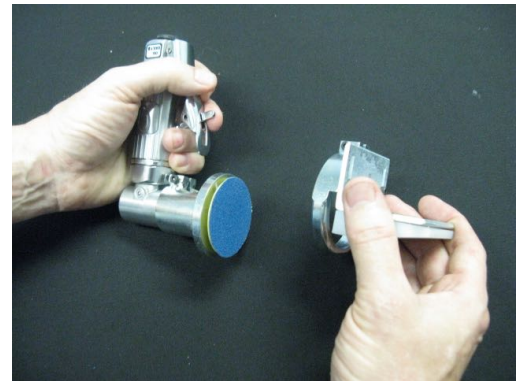

Remove the guide assembly. You may need to loosen one of the guide adjusting screws for the clamp to loosen.

## Adjusting the front facer

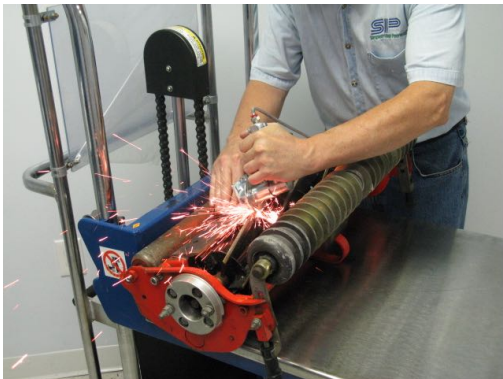

Pull the front facer back to the beginning of the bed knife then push it to the end of the bed knife. Repeat as necessary.

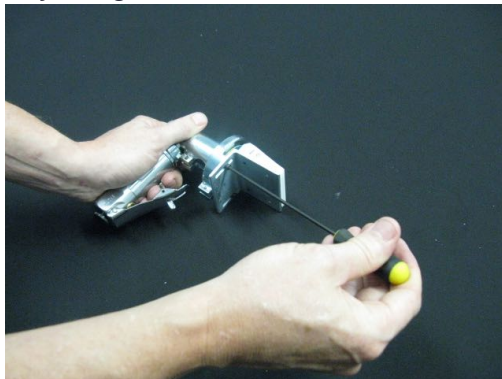

You can adjust the height of the guide by loosening the two socket head screws and sliding the guide up or down. If the front facer bogs down, you should adjust the fence up so that less of the disc surface contacts the bed knife.



Put your thumb in the hole of the facer and hold it against one of the flats. Untwist the disc and pull it off. Reverse the procedure for mounting the new disc.